

Power Steering System, V8

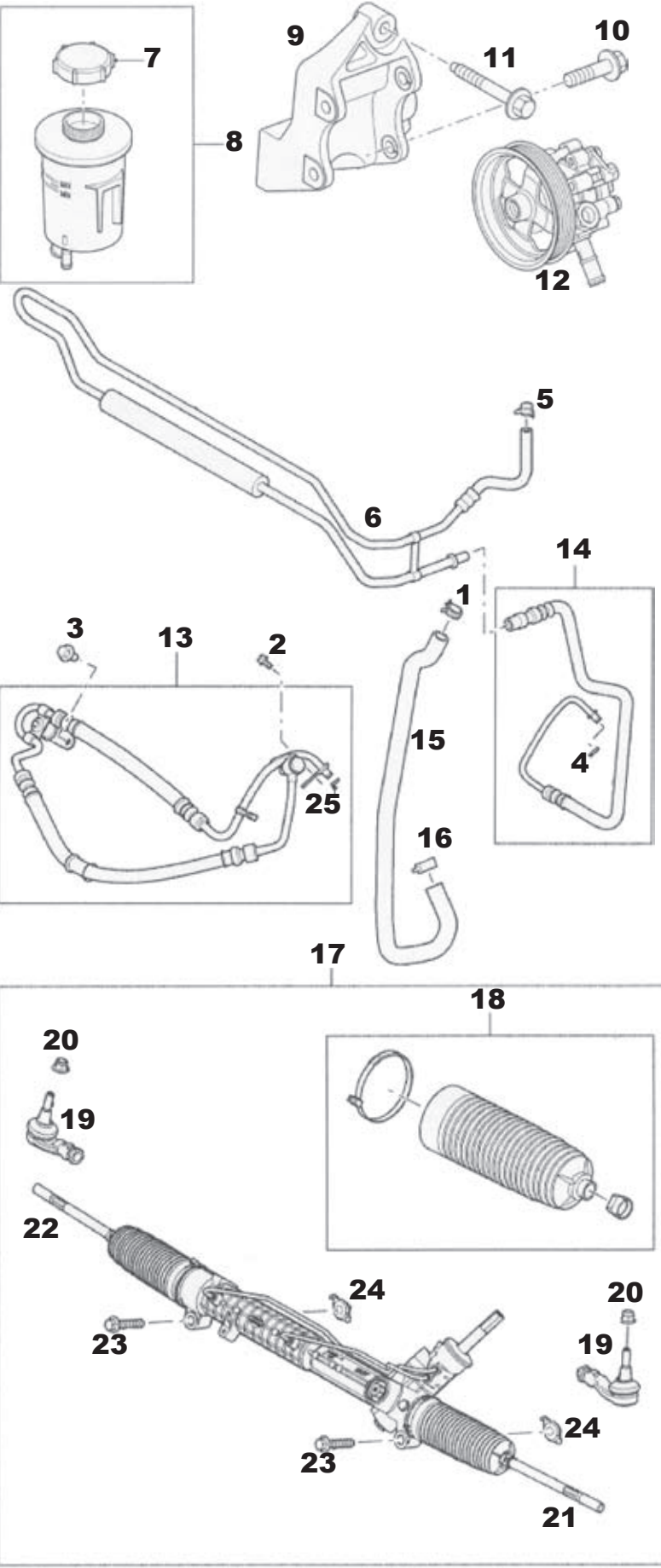

- | | |
|--------------------------------|-------------|
| (1) <u>Clamp:</u> | QGM000010 |
| (2) <u>Bolt:</u> | FS108127 |
| (3) <u>Banjo Bolt:</u> | FS106127L |
| (4) <u>Seal:</u> | CDU2327L |
| (5) <u>Clamp:</u> | QGM000020 |
| (6) <u>P/S Line:</u> | QGC500111 |
| (7) <u>Reservoir Cap:</u> | QEZ500010 |
| (8) <u>Reservoir Assembly:</u> | QFX500060 |
| (9) <u>Bracket:</u> | YLU500410 |
| (10) <u>Bolt:</u> | FS108307L |
| (11) <u>Bolt:</u> | FB108097 |
| (12) <u>P/S Pump:</u> | LR006329 |
| (13) <u>P/S Line:</u> | QEP500253 |
| (14) <u>P/S Line:</u> | QEP500333 |
| (15) <u>Hose:</u> | QEH000288 |
| (16) <u>Clamp:</u> | QGM000030 |
| (17) <u>P/S Rack Assembly:</u> | QEB500285 |
| (18) <u>Boot Kit:</u> | QFW500010 |
| (19) <u>Tie Rod End:</u> | QJB500010 |
| (20) <u>Nut:</u> | FY112056 |
| (21) <u>End Piece:</u> | QFK500010 |
| (22) <u>End Piece:</u> | QFK500020 |
| (23) <u>Bolt:</u> | FC114137 |
| (24) <u>Nut:</u> | QYH500160 |
| (25) <u>Seal:</u> | UYX1000060L |