

Spin on oil filter adaptor



If you are tired of having oil run down your sleeves while changing oil filters and finicky canister seals, why not convert to a more modern spin on oil filter. We have two designs available, coming with one hole per original style or two to accommodate your oil pressure light and oil pressure gauge without a Tee.

Oil filter adaptor, two hole
 Oil filter adapter, one hole
 Oil pressure sender unit
 Spin on oil filter

BPR1003
 BPR1003A
 90519864
 ERR3340G

11

Engine

Oil sump assembly

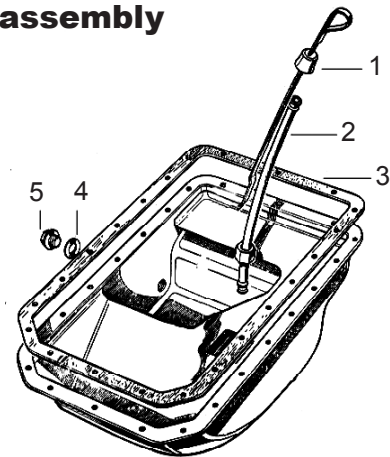

- | | |
|-------------------------|---------|
| 1 Dipstick | ETC7867 |
| 2 Tube, dip stick | 541860 |
| 3 Gasket, oil pan | 546841G |
| 4 Washer for drain plug | 243959 |
| 5 Drain plug | 536577 |

Oil pump assembly

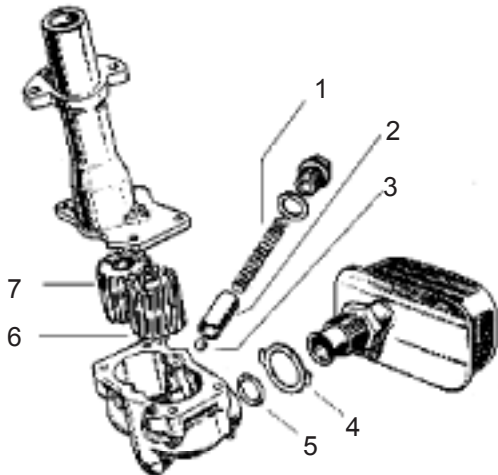

- | | |
|---------------------------------|---------|
| Oil pump, complete | ERR1117 |
| Lock washer, pump body mounting | 247665 |
| 1 Spring, relief | 564456 |
| 2 Relief spring plunger | 273711 |
| 3 Relief valve check ball | 3748 |
| 4 Lock washer | 244487 |
| 5 O-ring, inlet tube | 244488 |
| 6 Idler gear with bushing | 278109 |
| 7 Driven gear | 240555 |

Oil Filters

- | | |
|---|---------|
| Long cartridge filter, 6-13/16 inches | RTC3185 |
| Short cartridge filter, 4-5/8 inches | RTC3184 |
| Grommet, oil filter canister
(seals canister bolt opening at bottom) | 269889 |

Oil filler caps

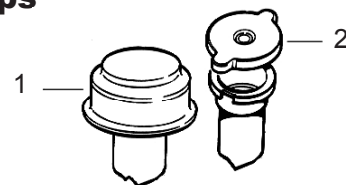

- | | |
|--|--------|
| 1 Breather type cap (pre-emissions) | NLA |
| 2 Sealed type cap (emissions controlled) | 598231 |

HELP LINE: 661-257-8634
 24 HOUR FAX: 661-257-9765



Check our web site for our **Specials**
www.britishpacific.com