

# Tech Tip

## II & IIA clutch releasing near the floor

If the clutch on your Series II or IIA releases close to the floor, you know your clutch cylinders are in good condition and no amount of bleeding helps, chances are very good that your mechanical clutch linkage is worn out and needs replacing.

The mechanical clutch linkage is often one of the most neglected systems on a Land Rover because it just works. Over time and without periodic lubrication the pivot pins become grooved, the spherical bushing wears out, and the holes in the arms become oval. Added up this can translate to a lot of freeplay. The clutch should be released when the pedal is about half way to the floor.

The bronze bushing is porous and should be soaked in oil for 24 hours prior to installation. Be sure to oil the felt washers on either side of the bronze bushing as well.

## Throw Out Bearing & Linkage, Series II, IIA

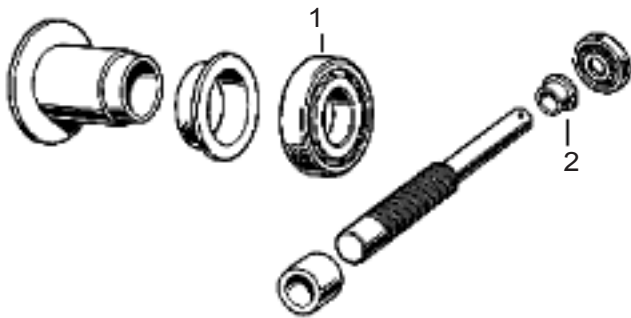

- |                      |          |
|----------------------|----------|
| 1 Bearing, throw out | STC1130  |
| 2 Seal, cross shaft  | 90214787 |

## Clutch Alignment Tool

There are few things harder than trying to slide a gearbox home when the clutch disc is misaligned.



CAT4

HELP LINE: 661-257-8634  
24 HOUR FAX: 661-257-9765



# Clutch

23

## Master clutch cylinders



- |  |            |
|--|------------|
| 1 Master cylinder, IIA from '69 & III    |            |
| OEM                                      | STC500100G |
| Aftermarket                              | 550732P    |
| Rebuild kit                              | 8G8837L    |
| Replacement cap                          | SJL500030  |
| 2 Master cylinder, Ser. II, IIA thru '68 |            |
| OEM                                      | 90569126   |
| Aftermarket                              | 90569126P  |
| Rebuild kit                              | 8G8837L    |
| Reservoir can, clutch & brake fluid      | 582980     |
| (Requires 588710 hydraulic line)         |            |

## Flywheel and Clutch

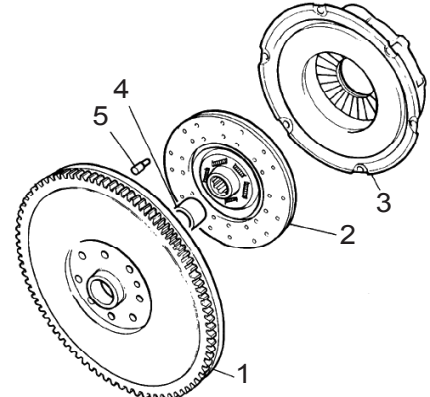

- |  |           |
|--|-----------|
| 1 Flywheel ring gear only                  | 506799    |
| 2 Clutch disc, 9" Ser. II & IIA thru '66   | 591704    |
| Clutch disc, 9.5" Late IIA, III            | 8510290G  |
| 3 Pressure plate, 9" Ser II & IIA thru '66 | 591705    |
| Pressure plate, 9.5" Late IIA              | 571228    |
| Pressure plate, 9.5" Ser. III              | 576557    |
| 4 Bushing, pilot                           | LFB500050 |
| 5 Dowel pin (3 req)                        | 502116    |
| Hose, flexible IIA '69 - '71               | RTC4425   |

Check our web site for our **Specials**  
[www.britishpacific.com](http://www.britishpacific.com)