

Hub and Stub Axle Assembly

Fits front and rear of both Rover and Salisbury axles through mid 1980.

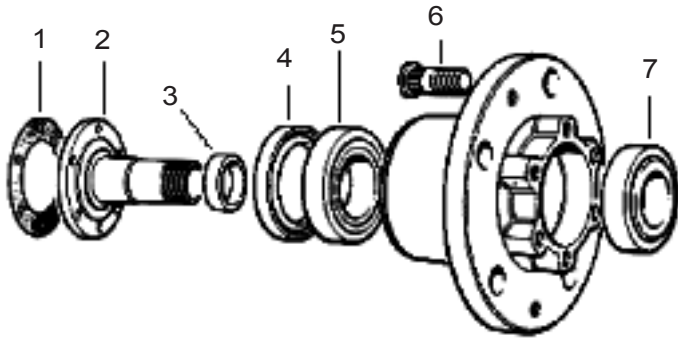

- | | |
|--|-------------|
| 1 Gasket | 277289 |
| 2 Stub axle, front | 599827 |
| Stub axle, rear | 599828 |
| Lock tabs for mounting stub axle (3 req) | 277311 |
| 3 Race for oil seal | 599698 |
| 4 Oil seal, standard duty, original type | RTC3510G |
| Oil seal, heavy duty, double lip | RTC3510 |
| Oil seal Oct. 1980 and newer | RTC3511 |
| 5 Bearing & race, inner hub to mid 1980 | |
| OEM | RTC3416G |
| Aftermarket | RTC3416P |
| 5 Bearing & race, inner hub to Oct 1980 on | |
| OEM | RTC3429 |
| 6 Wheel studs, IIA press fit | 561886 |
| Wheel studs, IIA Screw in | 561590 |
| Wheel studs, III Press fit | 576825 |
| Lug Nuts | See page 39 |
| 7 Bearing & race, outer hub to mid 1980 | |
| OEM | RTC3426G |
| Aftermarket | RTC3426P |
| 7 Bearing & race, outer hub to Oct 1980 on | |
| OEM | RTC3429 |

Wheel Bearing Adjusting Hardware

All models
front & rear

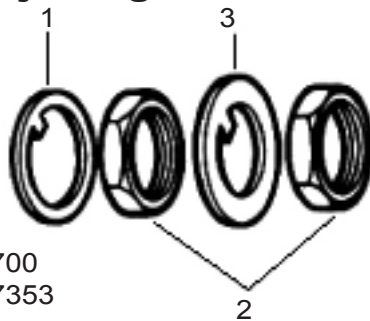

- | | |
|------------------|---------|
| 1 Key washer | 217352 |
| 2 Hub nut | FRC8700 |
| 3 Locking washer | 217353 |

Note: To adjust the wheel bearings without a dial indicator, tighten down the inner hub nut to remove any slack from the bearings then back off two flats of the nut. Check that the hub turns smoothly with little to no drag and there is no hub wobble. Slightly too loose is better than too tight.

HELP LINE: 661-257-8634
24 HOUR FAX: 661-257-9765



Hubs

35

Driven Hub Assembly

Superwinch brand Locking Hubs - Fits all 10 spline

RTC8162

24 spline hubs available. Call



Rover front & rear thru mid 1980

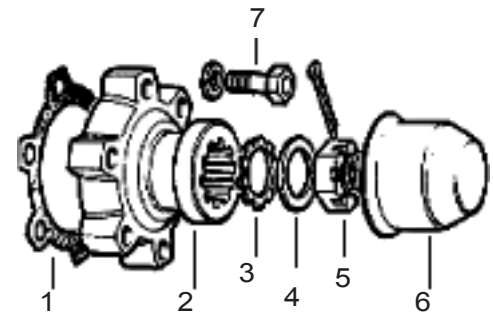

- | | |
|-------------------------------|---------|
| 1 Hub gasket | 231505 |
| 2 Hub, Driven | 571235 |
| 3 Felt seal | RTC3515 |
| 4 Washer | 571922 |
| 5 Nut, Castellated | 3259 |
| 6 Dust cover | 219098 |
| 7 Bolt (6 req) | 215331 |
| 'O' ring seal, after Oct 1983 | RTC3516 |

Salisbury thru mid 1983

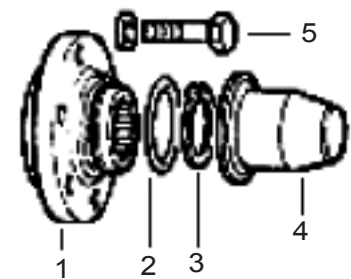

- | | |
|----------------|---------|
| Hub gasket | 231505 |
| 1 Hub, Driven | 571711 |
| 2 Washer | RTC3516 |
| 3 Circlip | 549473 |
| 4 Dust cover | 219098 |
| 5 Bolt (6 req) | 215331 |

Check our web site for our **Specials**
www.britishpacific.com